

Medium duty sealer for use with steel banding

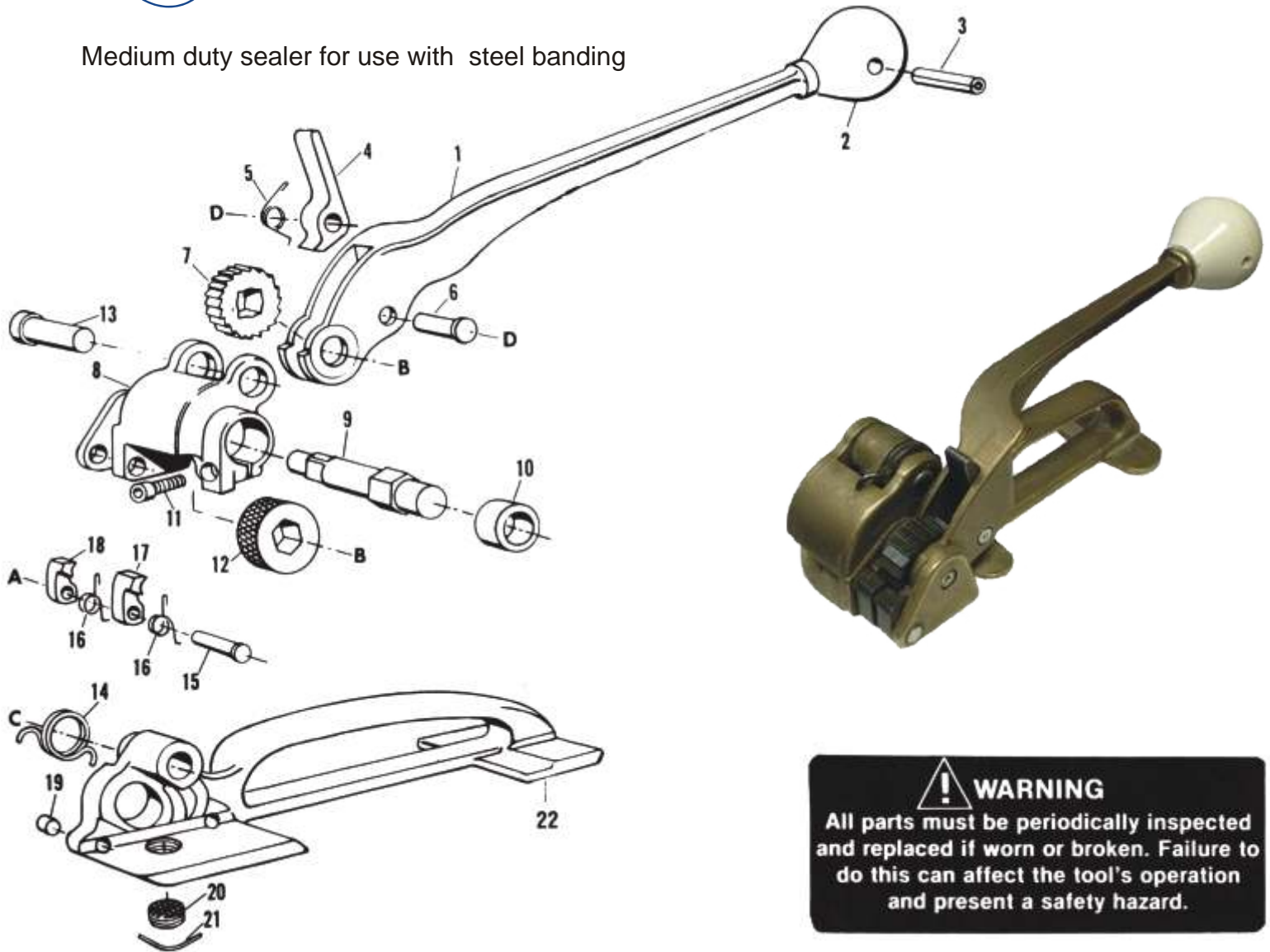

! WARNING
 All parts must be periodically inspected and replaced if worn or broken. Failure to do this can affect the tool's operation and present a safety hazard.

Key No.	Description	Qty.	Part No.	Key No.	Description	Qty.	Part No.
1	Handle	1	626A	12	Feed Wheel	1	762
2	Knob	1	752	13	Feed Wheel Support Pin	1	763
3	Roll Pin	1	753	14	Feed Wheel Support Spring	1	764
4	Handle Pawl	1	754	15	Retaining Pawl Pin	1	765
5	Handle Pawl Spring	1	755	16	Retaining Pawl Spring	2	766
6	Handle Pawl Pin	1	756	17	Long Retaining Pawl	1	767
7	Ratchet Gear	1	757	18	Short Retaining Pawl	1	768
8	Feed Wheel Support	1	758A	19	Strap Guide Pin	2	769
9	Feed Wheel Shaft	1	759	20	Clutch Plug Assembly	1	770
10	Bearing	1	760	21	Lock Wire	1	771
11	Cap Screw #10-32 x 5/8"	1	761	22	Base	1	627A